

Zero Biased Waveguide Detector With WR-12 to SMA Female and Negative Video Out Operating From 60 GHz to 90 GHz E Band, UG-387/U

FMMT3001 is an E Band Waveguide Detector. The Detector operates in the 60 GHz to 90 GHz Frequency Range and has a Negative Output with a Sensitivity of -600 mV/mW Minimum and -900 mV/mW Typical. The unit operates over a 0°C to +50°C Temperature Range and has a Maximum Input Power Rating of +20 dBm. The Detector has a WR-12 Waveguide with UG 387/U Flange as the RF connector and the DC Output Port uses an SMA Female Connector.

Electrical Specifications

Description	Min	Typ	Max	Unit
Frequency Range	60		90	GHz
Voltage Sensitivity	-600	-900		mV/mW
Input Power			+20	dBm

Mechanical Specifications

Temperature

Operating Range

0 to +50 deg C

Size

Weight

0.0625 lbs [28.35 g]

RF Connector

WR-12 Waveguide with UG-387/U Flange

DC Connector

SMA Female

Compliance Certifications (visit www.FairviewMicrowave.com for current document)

Plotted and Other Data

Notes:

- Values at 25 °C, sea level



Features:

- Frequency: 60 GHz to 90 GHz
- Sensitivity: -600 mV/mW Minimum; -900 mV/mW Typical
- Output: Negative
- Maximum Power Input 20 dBm
- RF Connector WR-12 Waveguide with UG 387/U Flange
- DC Output: SMA Female Connector

Applications:

- Test Lab
- Military Communications
- Commercial Communications

Fairview Microwave
1130 Junction Dr. #100
Allen, TX 75013
Tel: 1-800-715-4396 / (972) 649-6678
Fax: (972) 649-6689
www.fairviewmicrowave.com
sales@fairviewmicrowave.com

Typical Performance Data

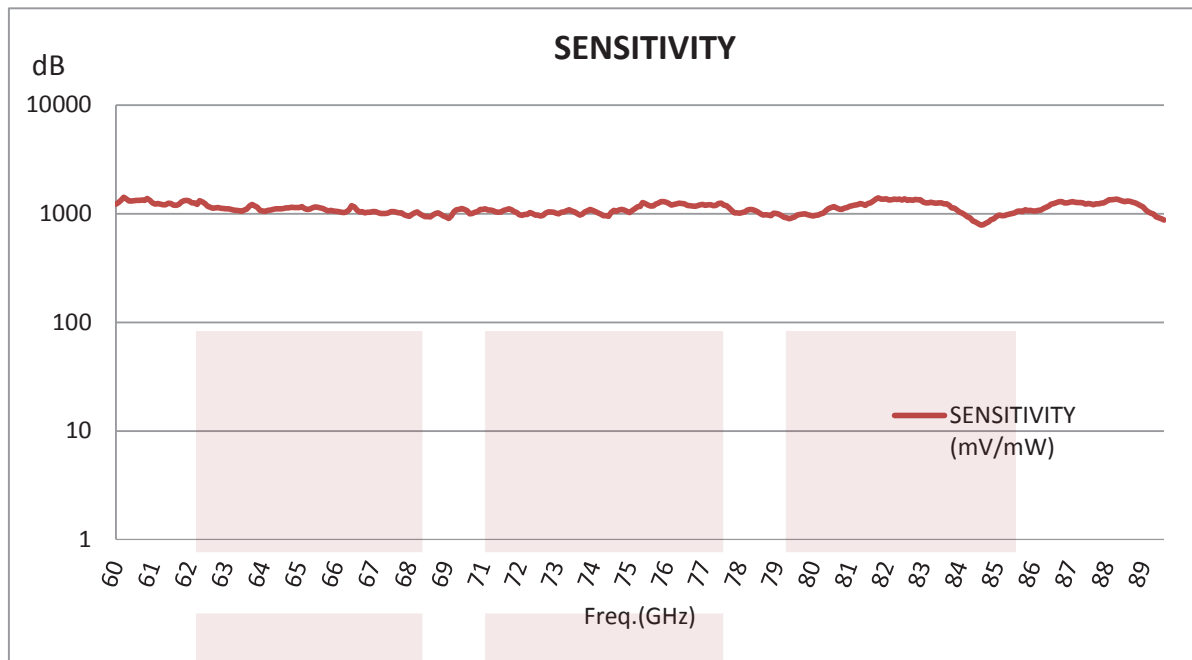

Zero Biased Waveguide Detector With WR-12 to SMA Female and Negative Video Out Operating From 60 GHz to 90 GHz E Band, UG-387/U from Fairview Microwave is in-stock and available to ship same-day. All of our RF/microwave products are available off-the-shelf from our ISO 9001:2008 certified facilities in Allen, Texas. Fairview Microwave is RF on-demand.

For additional information on this product, please click the following link: [Zero Biased Waveguide Detector With WR-12 to SMA Female and Negative Video Out Operating From 60 GHz to 90 GHz E Band, UG-387/U FMMT3001](http://www.fairviewmicrowave.com/zero-biased-waveguide-detector-wr-12-sma-female-negative-60-90-ghz-fm-mt3001-p.aspx)

URL: <http://www.fairviewmicrowave.com/zero-biased-waveguide-detector-wr-12-sma-female-negative-60-90-ghz-fm-mt3001-p.aspx>

The information contained in this document is accurate to the best of our knowledge and representative of the part described herein. It may be necessary to make modifications to the part and/or the documentation of the part, in order to implement improvements. Fairview Microwave reserves the right to make such changes as required. Unless otherwise stated, all specifications are nominal. Fairview Microwave does not make any representation or warranty regarding the suitability of the part described herein for any particular purpose, and Fairview Microwave does not assume any liability arising out of the use of any part or documentation.

UNLESS OTHERWISE SPECIFIED DIMENSIONS ARE IN INCHES. TOLERANCES ARE:	
DECIMALS	ANGLES
.XX ± .01	± 1/2° ± 1/64
.XXX ± .005	
FRACTIONS	
<u>HOLE DIAMETER</u>	<u>TOLERANCE</u>
.0135 TO .125	+.004/- .001
.126 TO .250	+.005/- .001
.251 TO .500	+.006/- .001
.501 TO .750	+.008/- .001
.751 TO 1.000	+.010/- .001
1.001 TO 2.000	+.012/- .001

* THESE DIMENSIONS AND TOLERANCES
SUPERSEDE NOTE #1 ON TITLE BLOCK.

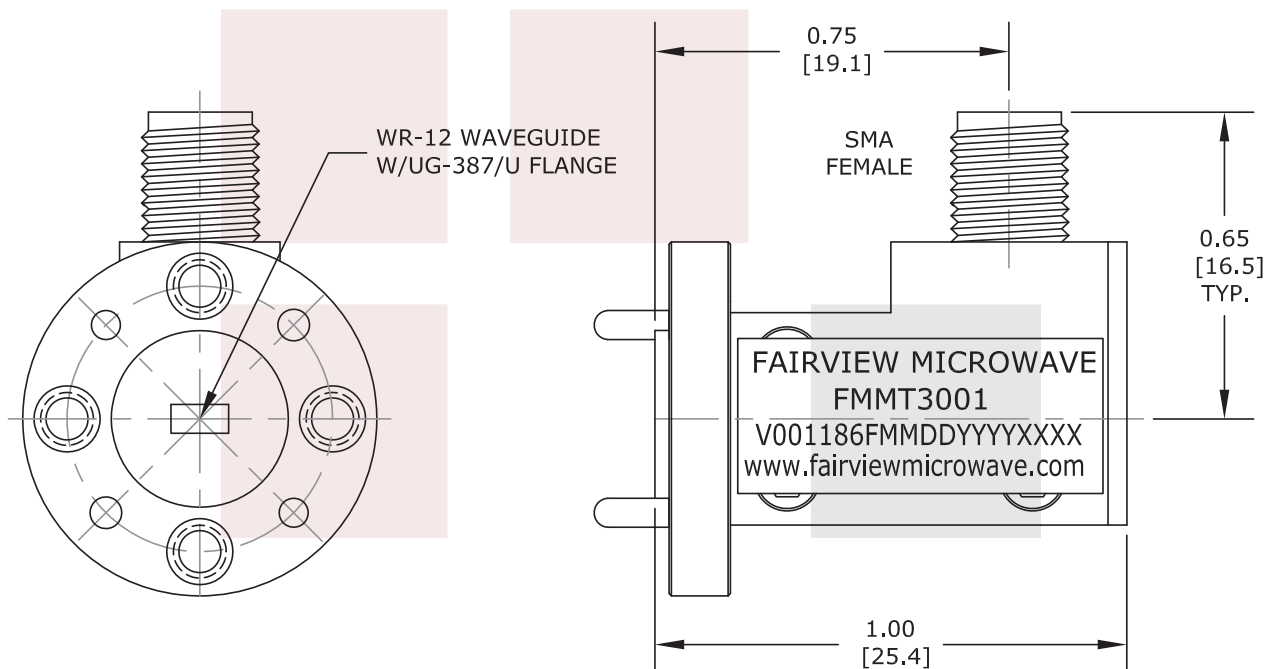
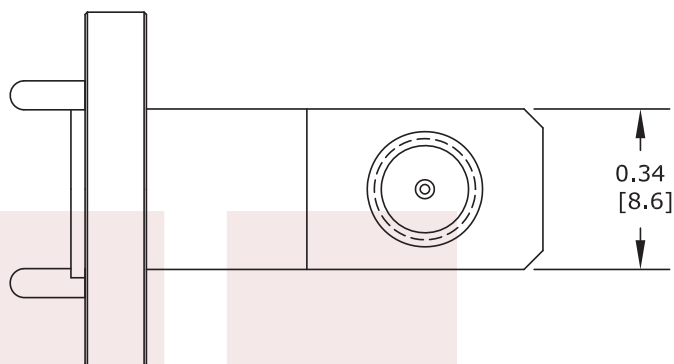

FAIRVIEW MICROWAVE INC. ALLEN, TX 75013 WWW.FAIRVIEWMICROWAVE.COM		NOTES: 1. UNLESS OTHERWISE SPECIFIED ALL DIMENSIONS ARE NOMINAL. 2. ALL SPECIFICATIONS ARE SUBJECT TO CHANGE WITHOUT NOTICE AT ANY TIME. 3. DIMENSIONS ARE IN INCHES [mm].			
TITLE Zero Biased Waveguide Detector With WR-12 to SMA Female and Negative Video Out Operating From 60 GHz to 90 GHz E Band, UG-387/U		DWG NO FMMT3001		CAGE CODE 3FKR5	
CAD FILE	040615	SHEET	SCALE	N/A	SIZE A 2233